

Data Sheet for Precision Resistor

Wirewound Resistor

Series ASTRO5

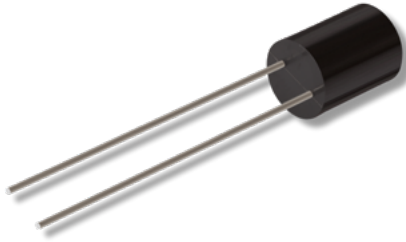

- Resistance range from 1Ω..1MΩ
- Exact values up to 0.005% resistance tolerance
- Temperature coefficients up to ±10ppm/°C (up to ±1ppm/°C on request)
- Resistance sets up to ±0.001% and ±0.5 ppm/°C
- Special lead wire bending on request
- Long-term stability ±100ppm/year (a very stable version with ±20ppm/year is available on request)

Electrical Specification	ASTRO5			
	100	125	250	700
Resistance range	1Ω..400kΩ	1Ω..750kΩ	1Ω..1MΩ	
Resistance tolerance	±0.005%..±0.1%			
Power rating (0W @ max. +145°C - see derating curve)	0.125W	0.25W	0.4W	0.5W
Max. working voltage	150V		300V	400V
TCR-rate	±10ppm/°C @ R > 100Ω ±20ppm/°C @ R = 10Ω..100Ω ±30ppm/°C @ R = 5Ω..10Ω ±50ppm/°C @ R = 1Ω..5Ω			
Working temperature range (max.)	-55 °C up to +145 °C			

Mechanical Specification	
Resistance technology / material	Wirewound / wire alloy
Housing material	Epoxy moulded
Connections	Radial cooper tinned

Data Sheet for Precision Resistor

Wirewound Resistor

Series ASTRO5

Power Derating Curve

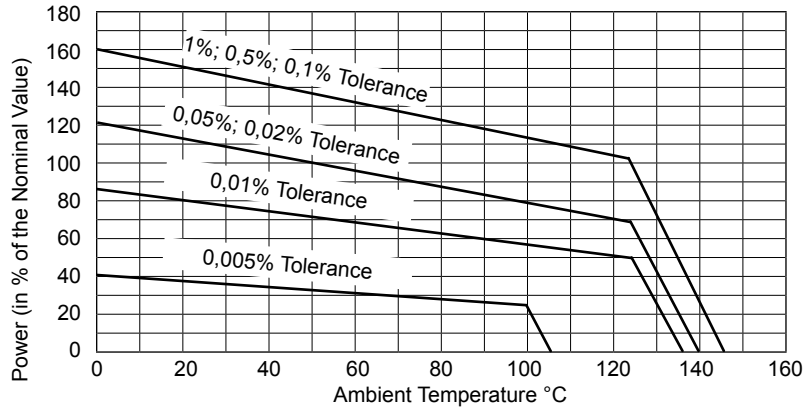

Drawing

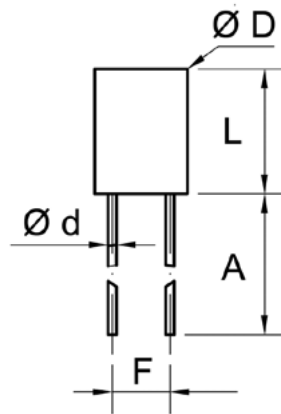

ASTRO5	A (min.)	L ($\pm 0,64$ mm)	$\varnothing D$ ($\pm 0,13$ mm)	$\varnothing d$ ($\pm 0,05$ mm)	F ($\pm 0,4$ mm)
100	25.0 mm	7.9 mm	6.4 mm	0.6 mm	5.1 mm
125	25.0 mm	12.7 mm	6.4 mm	0.6 mm	3.8 mm
250	25.0 mm	12.7 mm	9.5 mm	0.8 mm	5.1 mm
700	25.0 mm	12.7 mm	12.7 mm	0.8 mm	7.6 mm

Data Sheet for Precision Resistor

Wirewound Resistor

Series ASTRO5

Order code

Description	Selection: standard=black/bold , possible <i>options=grey/italic</i>				
Series:	ASTRO5				
Type / size:					
100 (max. 400kΩ)		100			
125 (max. 750kΩ)		125			
250 (max. 1MΩ)		250			
700 (max. 1MΩ)		700			
Resistance tolerance:					
±0.01% @ R >1Ω				W0,01%	
±0.005% @ R >100Ω				W0,005%	
Temperature coefficient:					
±10ppm/°C @ R >100Ω					TK10
±20ppm/°C @ R =10Ω..100Ω					TK20
±30ppm/°C @ R = 5Ω..10Ω					TK30
±50ppm/°C @ R = 1Ω..5Ω					TK50
Resistance value - please choose: From 1Ω to ≤ see type					xxxxkxxx

Order Example	Series	Type	Resistance tolerance	Temperature coefficient	Resistance value
Choice	ASTRO5	125	±0.01%	10ppm/°C	10,1kΩ
Code	ASTRO5	125	W0,01%	TK10	10k100