

Data Sheet for Precision Resistor

Wirewound Resistor

Series ASTRO5

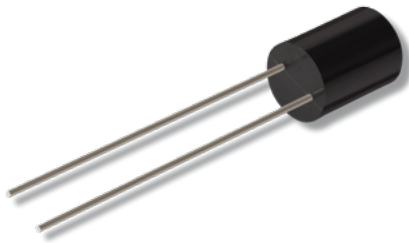

- Resistance range from 0,01..1MΩ
- Exact values up to 0.005% resistance tolerance
- Temperature coefficients up to ±10 ppm/°C (on request up to ±1ppm/°C)
- Resistance sets up to ±0.001% and ±0.5 ppm/°C
- On request, special lead wire bending
- Stable for a long time ±100 ppm/year (on request in a very stable version with ±20ppm / year)
- On request with Balco or platinum connectors for high TC values
- On request in very high or low TC configurations from -20 ppm/°C to +6000 ppm/°C

Electrical Specification	ASTRO5			
	100	125	250	700
Resistance range from 0,01Ω..	0,01Ω..500kΩ	0,01Ω..600kΩ	0,01Ω..800kΩ	0,01Ω..1MΩ
Resistance tolerance	±0,005%..±0,1%			
Power rating (0W @ max. +145°C - see derating curve)	0,125W	0,25W	0,4W	0,5W
Max. working voltage	150V		300V	400V
TCR-rate	±10ppm/°C @ R > 100Ω ±20ppm/°C @ R = 10Ω..100Ω ±30ppm/°C @ R = 5Ω..10Ω ±50ppm/°C @ R = 1Ω..5Ω ±90ppm/°C.. ±150ppm/°C @ R < 1Ω			
Working temperature range (max.)	-55..+145°C			

Mechanical Specification	
Resistance technology / material	Wirewound / wire alloy
Housing material	Epoxy moulded
Connections	Radial cooper tinned

Data Sheet for Precision Resistor

Wirewound Resistor

Series ASTRO5

Power Derating Curve

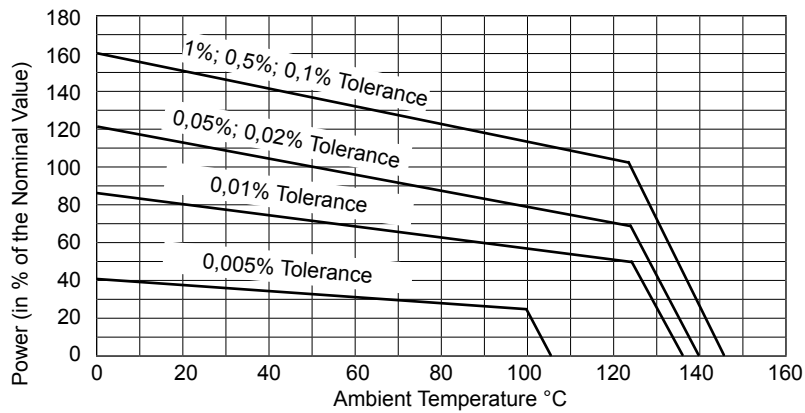

Drawing

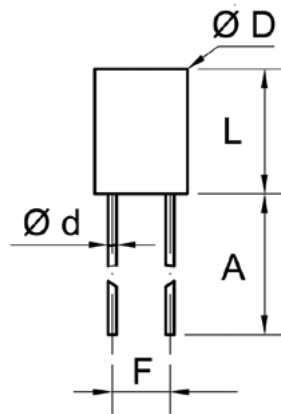

ASTRO5	A (min.)	L ($\pm 0,64$ mm)	$\varnothing D$ ($\pm 0,13$ mm)	$\varnothing d$ ($\pm 0,05$ mm)	F ($\pm 0,4$ mm)
100	25,0 mm	7,9 mm	6,4 mm	0,6 mm	5,1 mm
125	25,0 mm	12,7 mm	6,4 mm	0,6 mm	3,8 mm
250	25,0 mm	12,7 mm	9,5 mm	0,8 mm	5,1 mm
700	25,0 mm	12,7 mm	12,7 mm	0,8 mm	7,6 mm

Data Sheet for Precision Resistor

Wirewound Resistor

Series ASTRO5

Order code					
Description		Selection: standard=black/bold, possible options=grey/cursive			
Series:	ASTRO5				
Type / size:					
100 (max. 500kΩ)		100			
125 (max. 600kΩ)		125			
250 (max. 800kΩ)		250			
700 (max. 1MΩ)		700			
Resistance tolerance:					
±0,1% @ R >0,01Ω			W0,1%		
±0,05% @ R >0,1Ω			W0,05%		
±0,01% @ R >1Ω			W0,01%		
±0,005% @ R >100Ω			W0,005%		
±0,001% @ R >100Ω			W0,001%		
Temperature coefficient:					
±10ppm/°C @ R >100Ω				TK10	
±20ppm/°C @ R =10Ω..100Ω				TK20	
±30ppm/°C @ R = 5Ω..10Ω				TK30	
±50ppm/°C @ R = 1Ω..5Ω				TK50	
<i>Option ±90ppm/°C..±150ppm/°C @ R < 1Ω</i>				<i>TK90</i>	
Resistance value - please choose:					
From 0,01Ω to ≤ see type					xxxxkxxx

Order Example	Series	Type	Resistance tolerance	Temperature coefficient	Resistance value
Choice	ASTRO5	125	±0,1%	10ppm/°C	10,1kΩ
Code	ASTRO5	125	W0,1%	TK10	10k100