

**Series PEGMS**

Dimensions in mm

**TYPE B**

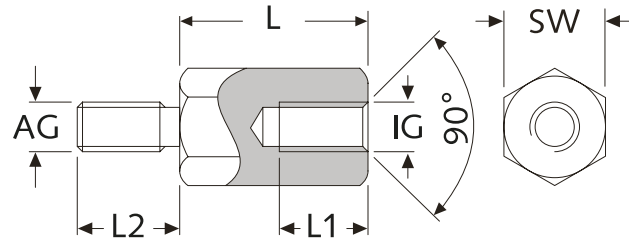

Example of order code Type B				
Article	AG = IG	L	Type	L2
PEG MS-M3-5-B	M3	5	B	6,0
PEG MS-M3-30-B (8 MM AG)	M3	30	B	8,0
PEG MS-M3-50-B (6 MM AG)	M3	50	B	6,0
PEG MS-M4-12-B	M4	12	B	8,0

**TYPE C**

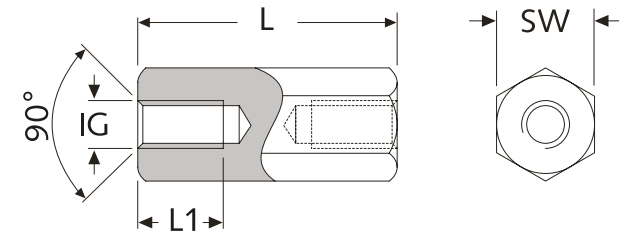

Example of order code Type C			
Article	AG = IG	L	Type
PEG MS-M3-25-C	M3	5	B
PEG MS-M4-25-C	M3	20	C
PEG MS-M3-18-C	M4	12	B

Type C			
IG	SW	L	
		min	max
M2,5	5	5,0	60,0
M3	5,5	5,0	70,0
M4	7	5,0	100,0

"IG" Type C		
L	L1	IG
5,0	5,0	M2,5 M3 M4
6,0	6,0	
8,0	8,0	
10,0	10,0	
12,0	12,0	
15,0	15,0	
18,0	9,0	
≥20,0	10,0	

Type B					
AG	IG	SW	L2	L	
				min	max
M2,5	M2,5	5	6,0	5,0	60,0
M3	M3	5,5	6,0/8,0	5,0	70,0
M4	M4	7	8,0	5,0	100,0

"IG" Type B		
L	L1	AG = IG
5,0	3,0	M2,5 M3 M4
6,0	4,0	
8,0	5,0	
10,0	6,0	
12,0	7,0	
≥15,0	10,0	